

Parcel Number	Street Address	Sale Date	Sale Price	Instr.
113-027-200-210-02	1861 W LAKE CIRCLE DR	05/20/22	\$165,000	WD
<b>Totals:</b>			<b>\$165,000</b>	

Parcel Number	Street Address	Sale Date	Sale Price	Instr.
060-007-300-035-00	180 N BARLOW RD	10/16/21	\$19,000	WD
060-007-300-035-00	180 N BARLOW RD	11/10/22	\$20,000	WD
060-026-200-025-00	5105 E WALLACE RD	10/25/21	\$85,000	WD
060-022-400-085-01	950 S EVERETT RD	07/28/22	\$80,000	WD
060-023-400-022-00	884 S US-23	12/21/21	\$129,900	PTA
061-105-000-004-00	5254 E CLARK RD	08/18/21	\$79,000	WD
061-110-000-005-00	5052 E HOLMES RD	07/30/21	\$25,000	LC
070-028-100-010-00	N SANBORN RD	07/08/22	\$4,500	WD
071-001-400-010-00	3731 N F-41	02/23/23	\$15,000	WD
101-035-200-008-01	831 W PROCUNIER RD	09/03/21	\$40,000	WD
<b>Totals:</b>			<b>\$497,400</b>	

*Column1*

Mean	6989.791899
Standard Error	1491.770419
Median	5640.205224
Mode	#N/A
Standard Deviation	4717.392271
Sample Variance	22253789.84
Kurtosis	-1.055648585
Skewness	0.34127021
Range	13708.8057
Minimum	379.8245614
Maximum	14088.63026
Sum	69897.91899
Count	10

Terms of Sale	Adj. Sale \$	Asd. when Sold	Asd/Adj. Sale	Cur. Appraisal
03-ARM'S LENGTH	\$165,000	\$51,100	30.97	\$112,448
	<b>\$165,000</b>	<b>\$51,100</b>		<b>\$112,448</b>
		<b>Sale. Ratio =&gt;</b>	<b>30.97</b>	
		<b>Std. Dev. =&gt;</b>	<b>#DIV/0!</b>	

Terms of Sale	Adj. Sale \$	Asd. when Sold	Asd/Adj. Sale	Cur. Appraisal
03-ARM'S LENGTH	\$19,000	\$8,900	46.84	\$20,227
03-ARM'S LENGTH	\$19,900	\$9,300	46.73	\$20,227
03-ARM'S LENGTH	\$85,000	\$29,800	35.06	\$67,678
03-ARM'S LENGTH	\$80,000	\$0	0.00	\$89,802
19-MULTI PARCEL ARM'S LENGTH	\$129,900	\$53,300	41.03	\$125,996
03-ARM'S LENGTH	\$79,000	\$27,200	34.43	\$62,505
03-ARM'S LENGTH	\$25,000	\$6,900	27.60	\$14,890
03-ARM'S LENGTH	\$4,500	\$5,400	120.00	\$10,898
03-ARM'S LENGTH	\$15,000	\$6,700	44.67	\$14,525
19-MULTI PARCEL ARM'S LENGTH	\$40,000	\$19,100	47.75	\$37,800
	<b>\$497,300</b>	<b>\$166,600</b>		<b>\$464,548</b>
		<b>Sale. Ratio =&gt;</b>	<b>33.50</b>	
		<b>Std. Dev. =&gt;</b>	<b>30.17</b>	

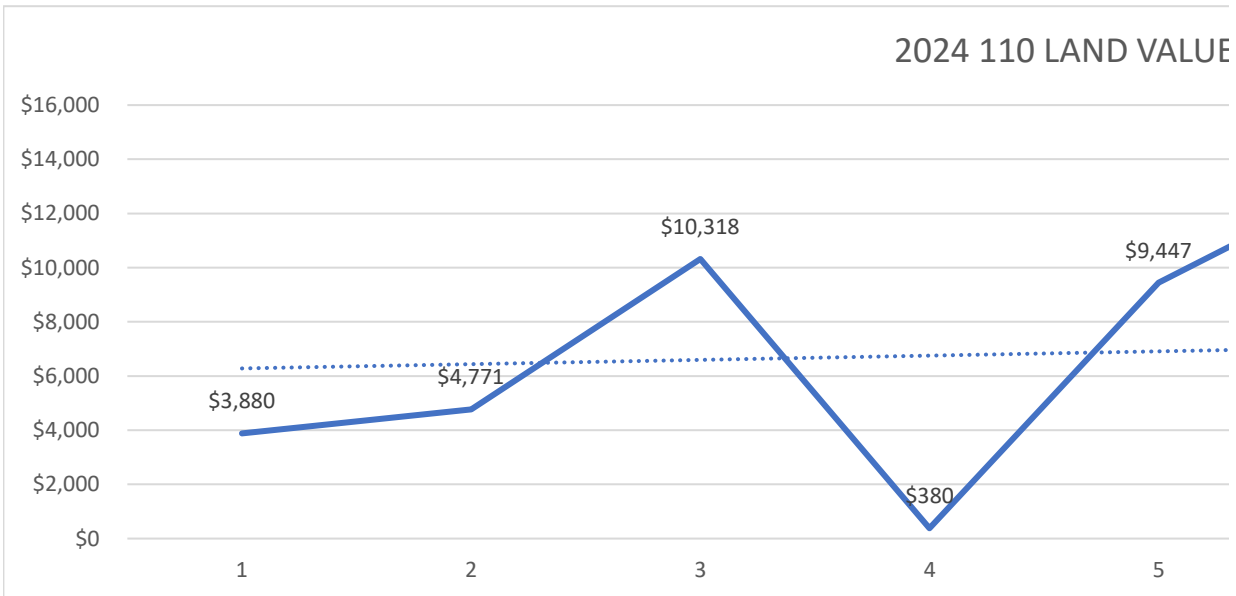

Land Residual	Bld. Value	Est. Land Value	Effec. Front	Depth	Net Acres	Total Acres
\$63,114	\$101,886	\$10,562	0.0	0.0	2.50	2.50
<b>\$63,114</b>		<b>\$10,562</b>	<b>0.0</b>		<b>2.50</b>	<b>2.50</b>
	<b>Average</b>		<b>#DIV/0!</b>		<b>Average</b>	
	<b>per FF=&gt;</b>				<b>per Net Acre=&gt;</b>	<b>25,245.60</b>

Land Residual	Bld. Value	Est. Land Value	Effec. Front	Depth	Net Acres	Total Acres
\$3,923	\$15,077	\$5,150	0.0	0.0	1.01	1.01
\$4,823	\$15,077	\$5,150	0.0	0.0	1.01	1.01
\$30,747	\$54,253	\$13,425	0.0	0.0	2.98	2.98
\$866	\$79,134	\$10,668	0.0	0.0	2.28	2.28
\$21,540	\$108,360	\$17,636	66.0	555.0	2.28	1.44
\$25,260	\$53,740	\$8,765	0.0	0.0	1.84	1.84
\$15,737	\$9,263	\$5,627	0.0	0.0	1.12	1.12
\$4,500	\$0	\$10,898	0.0	0.0	2.27	2.27
\$10,925	\$4,075	\$10,450	0.0	0.0	2.00	2.00
\$11,694	\$28,306	\$9,494	0.0	0.0	2.01	2.46

\$130,015		\$97,263	66.0		18.80	18.41
	<b>Average</b>				<b>Average</b>	
	<b>per FF=&gt;</b>		<b>1,969.9</b>		<b>per Net Acre=&gt;</b>	<b>6,917.16</b>

USE \$5800/ ACRE AS DATA USED OUTSIDE UNIT FOR 401  
 USE \$5336/ ACRE FOR 101

### FOR 1 ACRE PARCELS



Dollars/FF	Dollars/Acre	Dollars/SqFt	Actual Front	ECF Area	Liber/Page
#DIV/0!	\$25,246	\$0.58	0.00	401	2.022E+11

Average  
per SqFt=> **\$0.58**

Dollars/FF	Dollars/Acre	Dollars/SqFt	Actual Front	ECF Area	Liber/Page
#DIV/0!	\$3,880	\$0.09	0.00	401MH	2.021E+11
#DIV/0!	\$4,771	\$0.11	0.00	401MH	2.022E+11
#DIV/0!	\$10,318	\$0.24	0.00	401	2.021E+11
#DIV/0!	\$380	\$0.01	0.00	401	2.022E+11
\$326	\$9,447	\$0.22	66.00	401	2.021E+11
#DIV/0!	\$13,751	\$0.32	0.00	401	2.021E+11
#DIV/0!	\$14,089	\$0.32	0.00	401MH	
#DIV/0!	\$1,982	\$0.05	0.00	401	2.022E+11
#DIV/0!	\$5,463	\$0.13	0.00	401	2.023E+11
#DIV/0!	\$5,818	\$0.13	0.00	401MH	2.021E+11

Average  
per SqFt=> **\$0.16**

Other Parcels in Sale	Land Table	Gravel	Paved	Inspected Date	Use Code
	RESIDENTIAL 401	1	0	9/12/2016	

---

Other Parcels in Sale	Land Table	Gravel	Paved	Inspected Date	Use Code
	RESIDENTIAL 401	0	0	42597	
	RESIDENTIAL 401	0	0	42597	
	RESIDENTIAL 401	0	0	44841	
	RESIDENTIAL 401	0	0	42364	
060-023-400-025-00	RESIDENTIAL 401	0	1	34274	
	RESIDENTIAL 401	0	0	40056	
	RESIDENTIAL 401	1	0	40058	
	RESIDENTIAL 401	0	0	42622	
	RESIDENTIAL 401	0	0	43453	
101-035-200-008-05, 101-035-200-005-01	RESIDENTIAL 401	0	0	42606	

Class	Rate Group 1	Rate Group 2	Rate Group 3
401			

---

Class	Rate Group 1	Rate Group 2	Rate Group 3
401			
401			
401			
401			
401			
401			
401			
402			
401			
401			